

Wildflower meadow/Long grass



Play/view mound



Metal Seat/picnic table



Notes of works

- New resin bound aggregate paving with seat
- New turf area
- Long grass area cut once a year
- New tarmac paving
- New raised bed with new planting
- New bandstand
- New parkour equipment
- Remove all existing shrub and lay new turf
- Space for fresh food market
- New grass mound
- New seat and litter bin
- Metal picnic bench with wheelchair access
- Existing bollard/ New bollard
- Existing tree/ New tree
- Existing cobble paving to be cleaned and cemented in
- New carpet area

Proposed Plan - Option 2

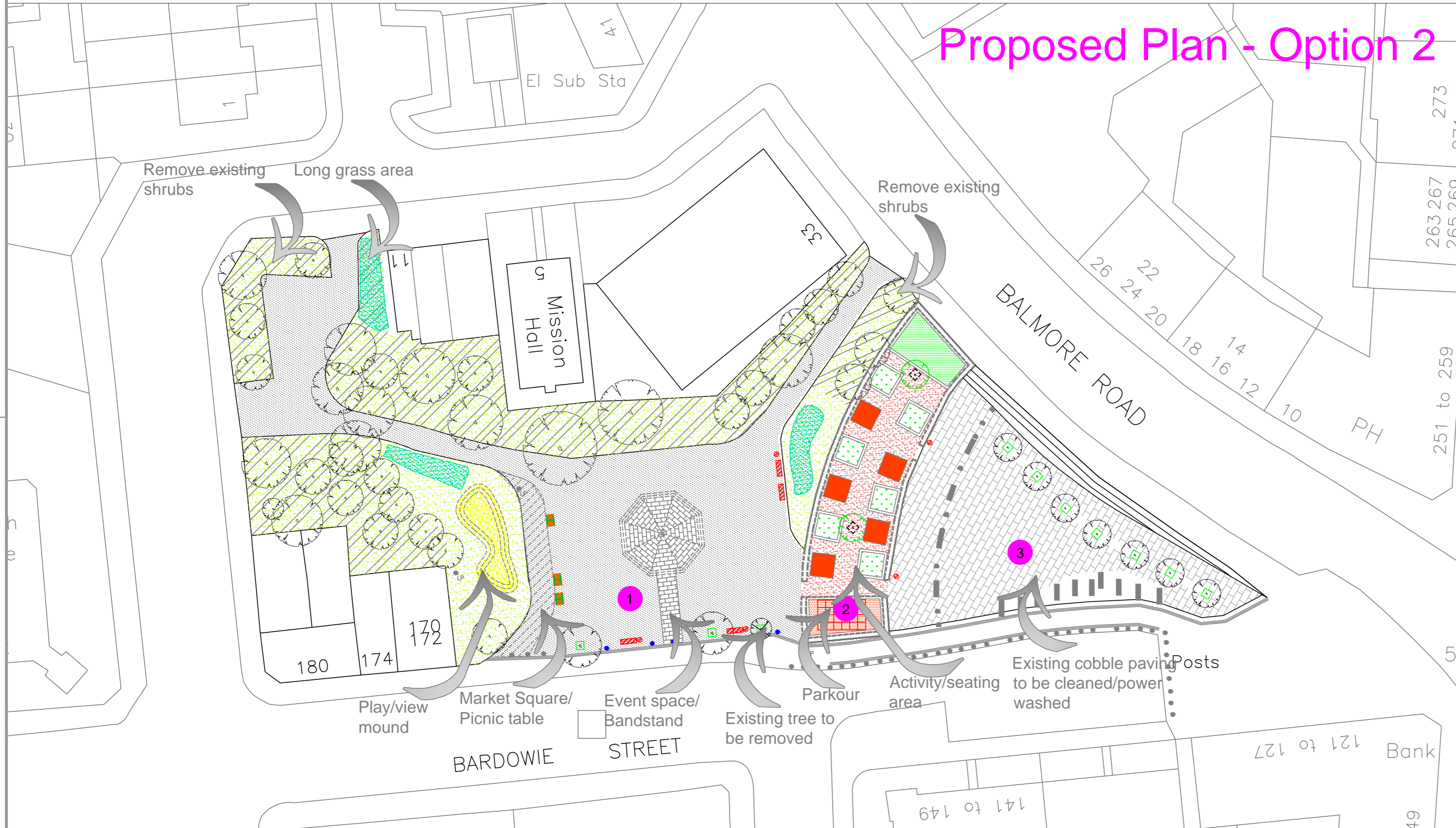

- Notes of works:
- 1 Resurfacing tarmac paving. Remove existing bandstand and metal fence. Remove existing shrubs and lift tree crown. Install new bandstand. install new picnic table seats and bins.
 - 2 Remove existing vegetation. Lay resin bound aggregate surface. Install raised beds and cube seats.
 - 3 Power clean/wash existing cobble.

Rev:	Date:	Revisions:	Checked Date:	Approved Date:
------	-------	------------	---------------	----------------

Glasgow City Council

Scale : NTS	Date : Nov 2015
Prepared By : LW	Checked By : PM
Director of Land & Environmental Services : Brian Devlin	
Design Office: Land & Environmental Services, Landscape Design, 231 George Street, Glasgow G1 1RX email: les@glasgow.gov.uk Tel: 0141 287 3903 Fax: 0141 287 3519	

1

Bandstand



2

Parkour



Raised Beds



Concrete Cube Seating



3

Existing Cobbles



Bandstand and Millennium Space
-
Proposed Plan
Option 2
-

Drawing No.:	5055_OP2
Rev.:	
File No.:	5055
Drawing Status:	Prelim Tender Contract Record
Client:	
Original Drawing Size	594 * 420 (A2)

Reproduced by permission of Ordnance Survey on behalf of HMSO. © Crown copyright and database right 2009. All rights reserved. Ordnance Survey Licence number 100023379.